

# X HD BUCKET ELEVATOR

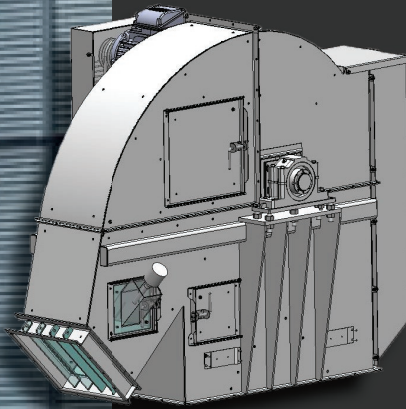

## HEAD SECTIONS

Heads are designed clean centrifugal discharge including:

- Heavy duty Crown faced double disc drum pulley with vulcanized rubber or replaceable slide lagging
- Heavy duty pillow block bearing, roller or ball style
- Adjustable bearing pedestals for simple belt tracking
- Inspection doors with heavy duty hinges and clamps, weather tight
- Engineered and machined steel shafts
- Adjustable discharge baffle plate
- Heavy duty construction with standard replaceable abrasion resistant steel, urethane, ceramic or any material based on customer specification
- Split hood with shaft seals
- Pressure relief door in hood with directional safety guard
- Bolt-on catcher bar assembly with removable bars for simple replacement - optional

## DRIVES

- Standard Dodge shaft mount with belt drives on smaller sizes or SEW for larger sizes.
- Alternate drive models available based on customer specifications
- Shaft mount with belt drive
- Alternate shaft combinations are available based on customer specifications or applications
- OSHA guards

## BELT & BUCKETS

- Heavy duty supreme oil resistant (S.O.R.) rubber belt engineered to suit the correct requirements for the application.
- All buckets based on the application and customer preference.
- All hardware options are available per customer specifications

## STANDARD FINISH OPTIONS

- Powder coating
- Wet/polyurethane paint
- Stainless steel
- Galvanized



Model	6	12	24	30	36	42	4821	4824	4832	4840
Max Bucket Size	6 x 4	7 x 5	12 x 6	14 x 7	16 x 7	16 x 8	16 x 8	20 x 8	13 x 8*	16 x 8*
Pulley RPM Min.	75	65	40	35	35	40	40	40	40	40
Pulley RPM Max.	195	130	75	70	70	65	62	62	62	62
Belt Speed FPM Min.	130	210	260	280	340	450	515	515	515	515
Belt Speed FPM Max.	330	425	480	560	675	730	795	795	795	795
Max Capacity CFH	2060	3500	7880	12500	16900	23100	25500	32130	38900	51000
Max Capacity BPH	1650	2800	6300	10000	13500	18500	20400	25700	31100	40800
Max Capacity MTPH	45	75	170	270	370	500	550	700	850	1100

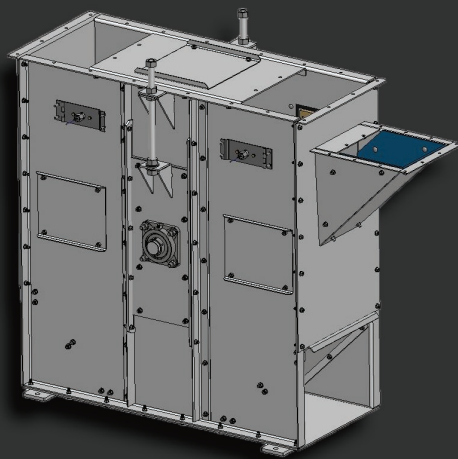

### BOOT SECTION

- Heavy duty Crown faced double disc drum pulley
- Heavy duty reinforced bolted construction provides a strong foundation.
- External flange or pillow block bearings
- Heavy duty threaded rod for screw take-up.
- Gravity take-up available based on project application
- Inspection doors with heavy duty hinges and clamps, weather tight
- Bolted assembly
- Comes with one Standard boot inlet
- Liners are available to suit your specifications and application

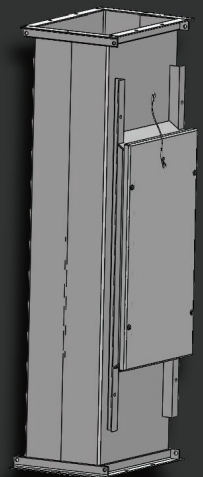

### LEG TRUNKING

- Fully seal welded on a laser aligned jig to ensure strength and resistance to weather conditions
- Standard Heavy duty construction
- Standard 10' -0" trunking sections
- Structural angle iron end flanges, Horizontal tie angles and cross bracing
- Heavy duty inspection trunking with large service and maintenance doors front and back

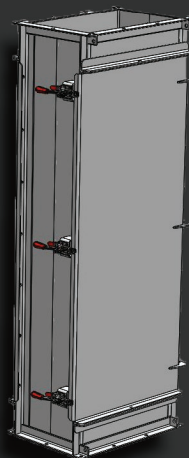

### STANDARD MAINTENANCE ACCESS OPTIONS

- Ladders and safety cages
- Head Service platforms
- Distributor platforms
- Step off and rest platforms

Safety and Monitoring sensors are available to suit your specifications and application

Note: all bucket elevator venting is designed to NFPA 61 and 68

